

CHASE-DURER

**OPERATION MANUAL**

**APOGEE GMT AUTOMATIC**



## Table of Contents

◆ Display / Crown and GMT Setting Pushbutton	1
◆ Setting Local TIME and DAY	2
◆ Setting Date and GMT	3
◆ Specifications	4

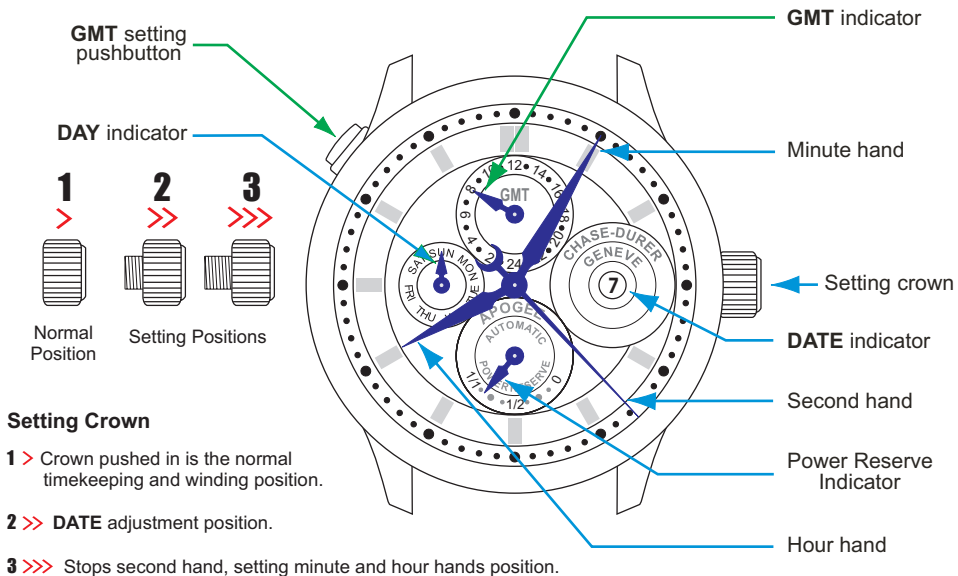

## WATCH HANDS

**WARNING:** Crown must be in position 1 at all times, use positions 2 and 3 for adjustments only. *Do not operate pushbutton under water!*

# Setting Local TIME and DAY

2.

**DAY\*** and **GMT** change each time hour hand passes midnight (24:00 hours)

Setting crown in position **3** is used to adjust both hour and minute hands\*\*

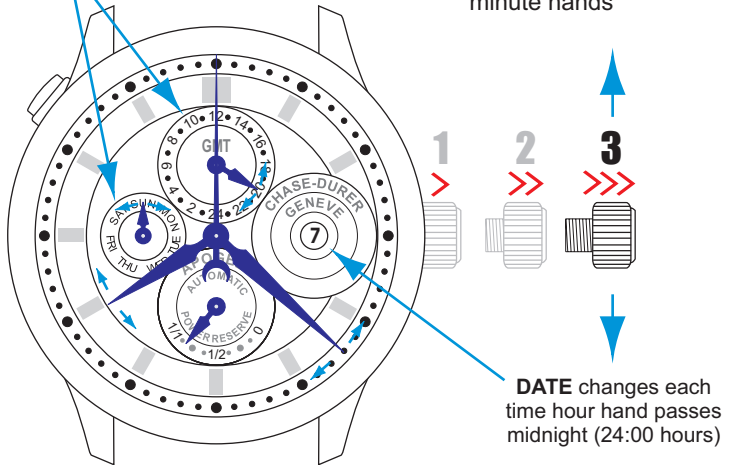

\*Setting the **DAY** is accomplished by advancing the hour hand through 24hour cycles. Every time the hour hand passes midnight, the indicator will advance to the next **DAY**. The hour hand may be moved through the 24hour cycles forward or backward depending on which day is closer to the indicator

\*\*Setting crown in position **3** Stops the Second Hand to allow synchronizing with a time signal. There are many accurate sources for this time signal including shortwave radio frequencies that continuously announce **GMT (UTC)** and the internet.

**GMT** (Greenwich Median Time) is an international time standard originally established to facilitate oceanic navigation and is based on the time in Greenwich, England from which the remaining 23 global time zones are derived.

**GMT** is 5 hours ahead of *Eastern Standard Time (EST)* and 4 hours ahead of *Eastern Daylight Time (EDT)* during Daylight Savings Time. So if the time is **0900 GMT**, it is 4:00AM in New York City and 1:00AM in Los Angeles during *Eastern Standard Time (EST)*, but during *Eastern Daylight Time (EDT)* it is 5:00AM in New York City and 2:00AM in Los Angeles. **GMT** is also referred to as Coordinated Universal Time (**UTC**) or Zulu Time (**Z**).

Pressing pushbutton  
advances **GMT**  
indicator

**DAY** changes each  
time hour hand  
passes midnight  
(24:00 hours)

**DATE** changes each time  
hour hand passes midnight  
(24:00 hours)

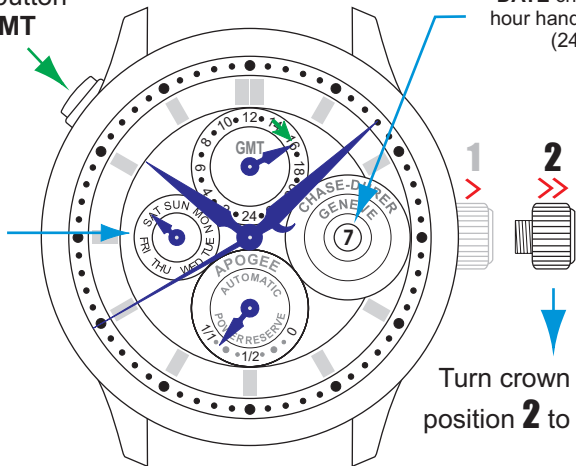

Turn crown backward in  
position **2** to set the **DATE**

## APOGEE GMT Technical Specifications

- ◆ SWISS MADE 30 jewel CD101A automatic specialty movement based on ETA 2892-A2.
- ◆ Features GMT, Calendar day dial & date window.
- ◆ Minimum 42-hour power reserve with indicator dial.
- ◆ Sapphire scratch-resistant crystal.
- ◆ Polished case in solid 316L stainless steel.
- ◆ Exhibition back.
- ◆ Movement decorated with perlage Cote de Geneve.
- ◆ Complimented with the finest handmade American Alligator bands.
- ◆ Water resistant to 150ft/46m.
- ◆ Serial numbered.
- ◆ Limited edition of 299 in Stainless Steel and 99 in 18K solid rose gold case.
- ◆ 2 year limited international warranty.

**ETA Cal. 2892-A2**  
**(APOGEE GMT AUTOMATIC)**

**CHASE-DURER**

9601 WILSHIRE BLVD. #1118

BEVERLY HILLS, CA 90210 USA

TEL: 800.544.4365 / 310.550.7280

FAX: 310.550.0830

E-MAIL: [CUSTOMER-SERVICE@CHASE-DURER.COM](mailto:CUSTOMER-SERVICE@CHASE-DURER.COM)

[www.chase-durer.com](http://www.chase-durer.com)